



Pro6 *Duo*

Steam Cleaner

Owner's Manual



For Home and Business

Index



Please read instructions carefully before operating your machine.



Pro6 Duo Features	Page 1
Important Safety Instructions	Page 2
Accessory Overview	Page 3
Accessory Overview	Page 4
Accessory Overview	Page 5
Accessory Overview	Page 6
Modify for Grout Line	Page 7
Grounding	Page 8
Start Up	Page 9
Maintenance	Page 10
Troubleshooting	Page 11
Technical Specifications	Page 12

Pro6 Duo Features

1. Pop off Reservoir Cap to add water to reservoir.
2. Cord Winder to wrap 14ft power cord securely for storage.
3. Fully adjustable Steam Output Regulator.

4. Pressure Gauge

5. The Low Water Light illuminates and the audible signal will also alert you when to add water to the reservoir.

6. The Steam Ready Light turns solid upon ready and flashes as boiler is heating during use.

7. Boiler Power Switch - Main Power

8. Steam Power Switch - Steam Power

9. Heavy-duty Hose Port with locking mechanism allows you to pull by the hose with no worry of damaging the connection.

10. Durable Wheels maneuver and glide where you need to go with ease.

11. Accessible Boiler Drain Plug

12. The Extended Rubber Bumper protects against damage done to your vehicles, furniture and shins during use. No Sharp Edges!



Important Safety Instructions

1. Carefully read the instructions contained in this handbook as they provide important information concerning use and maintenance.
2. Do not add detergents or other additives. Use only filtered water.
3. Safely store or dispose of the large plastic bag and any other packaging that is a suffocation hazard.
4. Do not operate the machine if there seems to be an issue. Contact qualified personnel.
5. Make sure the machine is plugged directly into a standard US electrical outlet.
6. Never remove the ground plug from the electrical cord.
7. Do not use extensions and/or adapters; whenever their use is indispensable, only use single adapters or multiple adapters and extensions complying with safety standards. Cords must be 12 gauge or heavier.
8. Do not use the product if the cord or plug are damaged. For possible cable replacement or repair, see Authorized Technical Assistance Center.
9. If the machine is dropped or tips over, immediately switch it off and disconnect the power plug. Do not use the product after any anomalous functioning.
10. This machine must only be used for the purpose for which it is expressly designed e.g., the cleaning and maintenance of surfaces. Any other use may be deemed improper and dangerous. The manufacturer cannot be held responsible for any damages due to improper, incorrect, or unreasonable use.
11. Do not operate the machine in the presence of explosives, highly flammable substances, gas or flames.
12. Never leave the machine unattended in the presence of children.
13. Do not allow children or anyone unfamiliar to operate the machine without adequate supervision.
14. Disconnect the plug from the socket before emptying the boiler and/or before any cleaning or maintenance operation.
15. When deciding to dispose of/discard the machine, make sure to render it unusable by cutting off the power cord! Also make sure to render harmless all those parts that could constitute a potential danger, especially for children.



WARNING! Danger - Never direct the steam jet at persons, animals, power outlets, electrical appliances or cleaning appliances.

Accessory Overview



1 x 9.5 Ft. Standard Hose

Durable 9.5 ft Flexible Hose with heavy duty brass port fittings.



1 x Triangle Brush w/ Clips

This brush can be used the same way as the Rectangle Floor Brush w/ Clips. You can also add a towel or pad and sanitize mattresses, couches, chairs and more.



1 x Window Squeegee

This accessory is suitable for windows, mirrors, doors, shower tiles etc.



2 x Extension Wands

Two rapid-assembly tubes are provided to obtain the length desired. Used together with the flexible hose, enables floor cleaning. Thermal insulation within the aluminum exterior.

Maximum Length: 95 inches.



1 x Extended Silicone Covered Jet Nozzle

This heavy duty extended nozzle is perfect for hard to reach areas around toilets, sinks and drains! It is used independently as a crevice tool.



1 x Single Hole Jet Nozzle *Best with Detail Brushes*

This nozzle is best used with small detail brushes and medium nylon brushes or independently for a more precise application.



1 x 3 Hole Jet Nozzle *Best with Medium Triangle Brush*

This three hole jet nozzle offers broader coverage. Designed with 3 ports that provide an equal steam flow. Connecting the nozzle to the medium triangle brush attachment enables the user to clean sinks, stove tops, ovens and more.

Accessory Overview



1 x Medium Nylon Triangle Brush

Our medium nylon triangle brush has three pressure points for optimum cleaning when combined with the three hole jet nozzle. This brush can be used on stove tops, counters, sinks, dishwasher interior, fridge interior, glass shower doors etc.



1 x Medium Nylon Round Brush

This accessory can be used on the same surfaces as the medium triangle brush. Insert a metal scrubby and attach your 3 hole nozzle to increase the temperature.



2 x Stainless Steel Scrubbies

Enhance your cleaning by inserting these scrubbies in the medium nylon brushes with the provided three hole jet nozzle. When combined with the super heated steam, they will conduct heat increasing the "tip" temperature.



2 x Microfiber Towels

These 16 x 16 microfiber towels are an essential when steam cleaning. The fibers act as a trap, collecting all of the dirt and grime that was loosened from steaming and they are machine washable.



1 x Filler Bottle w/ Cap

1.2 liter Capacity Fill Bottle with Cap

Accessory Overview

10 x Detail Brushes

8 Nylon, 1 Stainless and 1 Brass Detail Brush. These brushes are very versatile and best used with your single hole jet nozzle.



(See page 7 for modifying detail brushes to fit your grout line.)

1 x Replacement O-Ring Kit

1 x Large O-Ring is for the water level sensor (only replaced by qualified technician).

2 x Medium O-Rings are for the Extension Wands and Nozzle.

2 x Small O-Rings are for the boiler drain plug and mono-block nipple.



A little Vaseline or dielectric grease applied on your O-Rings will increase their lifespan.



Check the O-rings on the safety handle for damage.

Pos. (1)



Pos. (2)

Check the O-rings on the connector for damage.



Pos. (3)

Check the O-rings on the extension wands for damage.

All the accessories are fitted the same way. Fit the required accessory on the gun of the flexible hose.

Caution! Make sure to work initially with a weak steam flow and increase the steam setting accordingly by operating your steam regulator knob (3).

Accessory Overview



1 x Rectangle Floor Brush w/ Clips & Carpet Glider

This brush is for all hard surface floors such as tile, wood, linoleum, concrete etc.

Typically used with a microfiber towel clipped around. For more delicate hard surface floors such as wood, always use with a microfiber towel or pad.

Carpet Glider

The Carpet Glider covers the bristles on the floor brush, allowing the user to sanitize rugs and carpets without damaging the fibers. Can be used with or without a towel clipped on. The glider can be removed when you are ready to clean hard surface floors.

Carpet Glider Disassembly

Cleaning Hard Surface Floors

To remove glider, use the open side (fig.1). Release the locking fixtures by tapping gently (fig.2 and fig. 3) to remove the glider cover completely (fig.4).

Carpet Glider Re-assembly

Cleaning Carpets & Rugs

To assemble glider, position accessory on the floor brush (fig. 5). Press so that the glider slides neatly in the grooves (fig. 6) until it reaches the locking fixtures (fig. 7). To lock in - tap lightly (fig. 8) until the bristles are aligned evenly with the glider.

Set steam setting to medium to low. Then disassemble the glider and clean with the brush wrapped in a microfiber towel or pad.

For stubborn dirt or residuals of previously used chemicals, several treatments may be necessary in order to obtain a satisfactory and even result. For subsequent treatment, repeat the procedure using a dry rag wrapped on the brush.

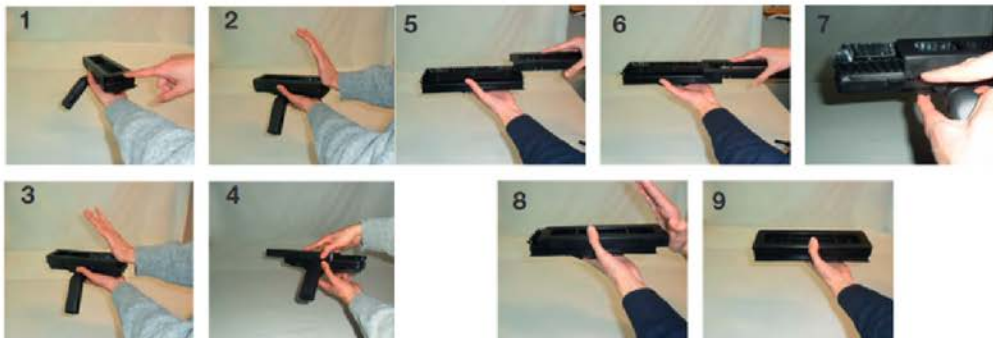

Modify Detail Brushes for Grout Line (Optional)

Nylon

The nylon brush is the least aggressive brush, yet sometimes the most productive. Safe for nearly all surfaces; it's great for tile, minimally dirty grout, sinks, microwaves, aluminum tracks, anywhere you need to clean. Nylon brushes help to remove particles from crevices. Metal brushes will conduct heat and provide a more aggressive cleaning when necessary.

Brass

Brass is a relatively soft metal. It is good on surfaces that need a little more scrubbing power than the nylon brush can offer. The brass is less likely to harm surfaces than the hard steel. Brass can often be used on shower grout but is not recommended for floor grout as it wears down quickly and can leave a residue that will need to be cleaned later. Grills and Jen Air's are good examples for using the brass brush.

Stainless

Best for Grout

Combined with steam it is the most powerful of the brushes by utilizing the steel to conduct heat and the aggressive contact made for cleaning any surface that can be cleaned with stainless. Form the brush to fit in the appropriate grout lines by following the instructions below.



To prepare the brush for cleaning, grasp the detail brush in one hand, with the other hand use a pair of needle nose pliers. Grab the steel at the base where the tuft is attached. Use a circular twisting motion to pull the steel out of the plastic base.

The width of the brush will depend on the style of grout you are cleaning. For example, Mexican tile, 3 tufts top and bottom. Standard 12 or 18 inch tiles will normally need a brush with 2 tufts at the top and 2 at the bottom.

Always test an inconspicuous area before you start cleaning. Do not use on any type of plastic or painted surfaces. Only use this on ceramic tile grout, cement, rusty metal or your outdoor grill or other surfaces you are confident about using it on. Be sure to test first.

Grounding Instructions

This machine must be grounded. If it should malfunction or breakdown, grounding provides a path of least resistance for electric current to reduce the risk of electrical shock. This machine is equipped with a cord having an equipment-grounding conductor and grounding plug. The plug must be inserted into an appropriate outlet that is properly installed and grounded in accordance with all local codes and ordinances.

WARNING - Improper connection of the equipment-grounding conductor can result in a risk of electric shock. Check with a qualified electrician or service person if you are in doubt as to whether the outlet is properly grounded. Do not modify the plug provided with the machine - if it will not fit the outlet, have the proper outlet installed by a qualified electrician.

The machine is for use on a normal 120-Volt circuit and has a grounding attachment plug that looks like the plug illustrated in (Figure). Make sure that the appliance is connected to an outlet having the same configuration as the plug. No adapter should be used with this machine.

SAVE THESE INSTRUCTIONS

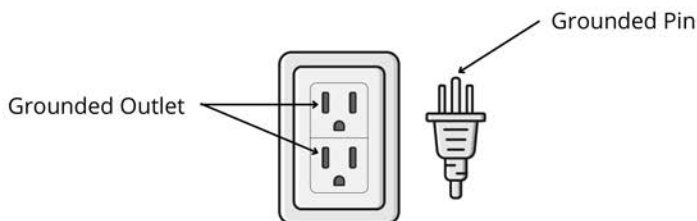

Start Up

Remove the tank cap (1), and fill the tank with approx. 2 liters of filtered tap water. Distilled water can also be used only if combined with approximately 1 cup of filtered tap water per liter of distilled. Replace the cap and connect the power cable to the electrical socket. The cap is designed to loosely fit the machine. It does not screw on or lock in place. Turn the machine on by pressing both switches (7) and (8). When the steam ready light (6) is flashing, the machine is heating. Once the steam-ready light turns solid the machine is ready for use. Once the machine is in use, the light will begin flashing again and this is normal.

Open the flap to the mono-block socket (9) and connect the grip unit plug. Make sure to correctly fit the plug.

When device is heated and ready for operation, press steam trigger on hose while adjusting the steam regulator knob (3) according to the application. A medium to low setting is recommended for most surfaces. A high setting is recommended for heavily soiled surfaces.

Attention! In the event of sudden power failure or accidental disconnection of the plug from the main outlet, the unit switches to safety mode. To restore the normal conditions of use disable and re-enable switch (7).

Continuous Filling

This machine is designed for continuous refill. If the water finishes, the boiler can be filled without switching the machine off and waiting for cool down. When the low water light illuminates (5) and you hear the audible signal to refill, simply remove the tank cap (1) and add water, close the cap and resume cleaning.



IMPORTANT! We recommend filtered tap water in this machine. Distilled water is not suitable for this type of machine unless mixed with filtered tap at minimum ratio of 20% tap / 80% distilled. Do not use well, softened water or water that is high in mineral content. Do not use a reverse osmosis home system unless mixed with filtered tap.

Maintenance

! **IMPORTANT! Before all maintenance operations, make sure the machine is turned off and the power cord is not connected to the main power supply.**

1. After use of the brushes, to prevent undue deformation, allow the bristles to cool in their normal position.
2. Occasionally check O-Rings for cracks and apply Vaseline if needed.
3. Maintain your boiler by draining the water and descaling if the machine was stored for an extended period of time (3+ Months). Follow the instructions below to descale your machine.

Get the most out of your machine by visiting our product page when you scan the barcode. You will find FAQs, maintenance and more!

To scan, open camera app on mobile device and hover over barcode.



Flushing & Descaling

The frequency of descaling depends on the quality of water used and length of time water has remained in your boiler, causing mineral deposits to build. To slow the collection of mineral deposits, it is suggested to flush your machine by emptying the water from the bottom boiler and top reservoir and refill with clean water at least every three months.

Descaling with White Distilled Vinegar

1. Unscrew and remove the drain plug from the bottom of the machine.
2. Drain the machine completely.
3. Put the drain plug back in the machine.
4. Pour 2 cups of white distilled vinegar in the reservoir and fill the rest with filtered tap water.
5. Turn on the machine and let the pump start pumping the mixture through the machine and into the boiler.
6. When the unit no longer signals for more water, turn off the machine and let the mixture rest in the boiler for no less than 3 hours up to overnight. **(Do not fully heat the mixture).**
7. Empty the vinegar from the bottom drain plug and the top reservoir.
8. Refit the plug and refill with good quality tap water or bottled drinking water.
9. Continue normal operation.

Technical Specifications

Power Supply	120V-60Hz
Boiler Power	1750W
Tank Capacity	2 Liter
Steam Pressure	6 Bar / 600 kPa
Steam Temperature	155° C
Max Power	1800W
Boiler Internal Capacity	1.8 Liters
Voltage	110 - 120V
Dimensions	12 x 12 x 11.5
Weight	16 lbs
Power Cord	14 Ft.
Hose Length	9.7 ft w/ Safety Handle
Boiler	Stainless Steel AISI 304
Automatic Safety Shutoff	Yes
Pressure Regulator Knob	Yes - Full Range
Audible Low Water Signal	Yes

Composition

Casing in stainless steel
Boiler in stainless steel
Pressure switch set to 6 Bar
Steam outlet control solenoid valve
Silicone electrical wires

Safety

Temperature safety thermostat
Safety valve
Extra low voltage on the handle



Troubleshooting

Problem	Cause	Solution
Boiler fails to heat	<ul style="list-style-type: none">• Device not plugged in• Button (7) or (8) not pressed• Boiler is empty	<ul style="list-style-type: none">• Plug into outlet• Press button (7) & (8)• Fill tank water
Machine Safety	LED off mode	Switch off and on switch (7)
Steam ready LED comes on but no steam comes out	<ul style="list-style-type: none">• The mono-block socket (hose) is not completely fitted• The steam regulator (3) is completely closed	<ul style="list-style-type: none">• Check mono-block socket (hose) is correctly fitted to machine• Open the steam regulator (3)
Yellow LED (5) is on	Low water level	Fill tank water
No steam or only water coming out	<ul style="list-style-type: none">• Boiler not ready yet• Amber LED is blinking• Boiler is overfilled, too much distilled water	<ul style="list-style-type: none">• Wait for steady amber LED• Drain the boiler and refill

Disposal



According to Directives 2011/65/EU and 2012/19/EU on the reduced use of hazardous substances in electrical and electronic equipment, and their disposal, the barred bin symbol means that after the end of its useful life the product must be disposed of separately from ordinary waste.

The user must therefore take such equipment to proper collection centers for electrical and electronic waste, or take it back to the dealer when he or she buys some equivalent equipment, in the ratio of 1;1.

A suitably differentiated waste collection, followed by recycling, treatment and environmental

friendly disposal helps prevent negative effects on health and the environment and favors the recycling of materials.

Any unauthorized equipment disposal by the user will be subject to sanctions as provided for by current local regulations.



Intertek